



9 & 12

PLAN A

2 BEDROOM

ENCLOSED AREA

655
SQ. FT.

BALCONY/TERRACE

120
SQ. FT.

TOTAL AREA

775
SQ. FT.

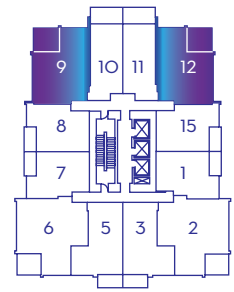

Actual suite plan may have minor variations from, or shown as mirror image of, the typical plan shown.

LOWER TYPICAL FLOORS 5-40

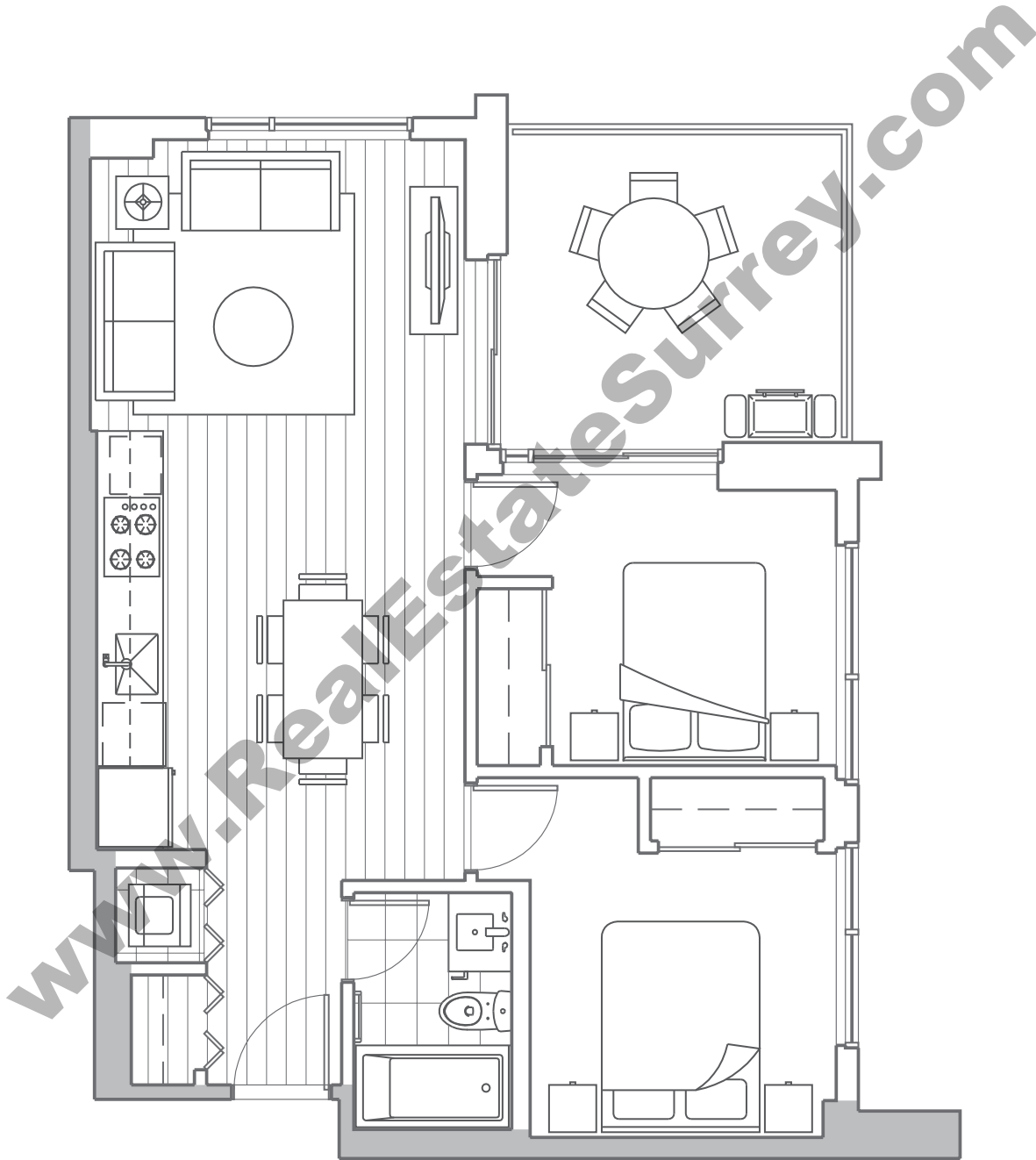

The developer reserves the right to make modifications and changes to features and finishes, brands, materials, building design, specifications, features, ceiling heights, flooring patterns and floor plans without notification. Suite sizes are computed 0.015m offset from the outside face of exterior walls, 0.015m offset from the outside face of walls adjacent to common areas and to the centreline of walls common to other suites. Measurements for exterior balconies and terraces are computed from the outside face of exterior walls to the slab edges of the outside face of parapets. All illustrations reflect the artist's interpretation of the project and do not take into account the neighbourhood buildings, physical structures, streets and landscape. These materials will be governed entirely by the terms of the applicable disclosure statement and purchaser contract in each case. This is not an offering for sale. Any such offering can only be made with the applicable disclosure statement. Concord Park Avenue Limited Partnership. E&OE



10 & 11

PLAN B

1 BEDROOM

ENCLOSED AREA

446
SQ. FT.

BALCONY/TERRACE

96
SQ. FT.

TOTAL AREA

542
SQ. FT.

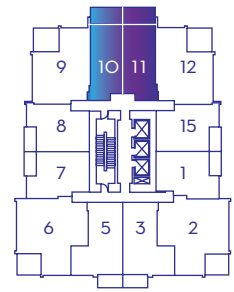

Actual suite plan may have minor variations from, or shown as mirror image of, the typical plan shown.

LOWER TYPICAL FLOORS 5-40

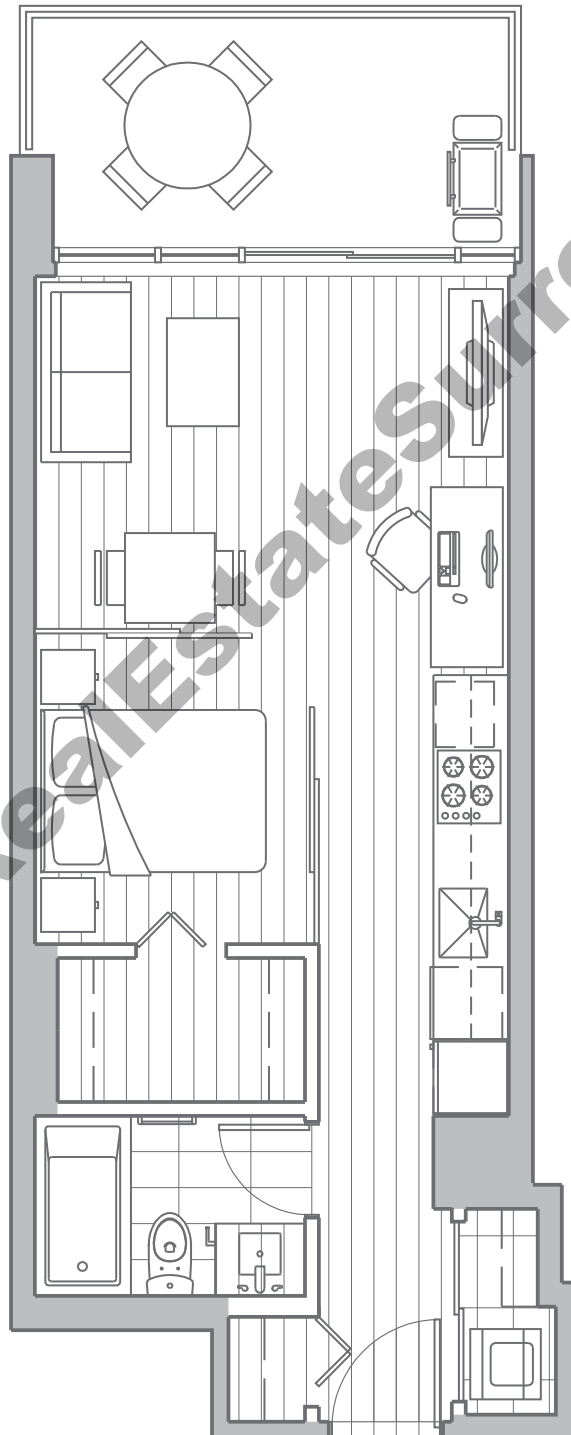

The developer reserves the right to make modifications and changes to features and finishes, brands, materials, building design, specifications, features, ceiling heights, flooring patterns and floor plans without notification. Suite sizes are computed 0.015m offset from the outside face of exterior walls, 0.015m offset from the outside face of walls adjacent to common areas and to the centreline of walls common to other suites. Measurements for exterior balconies and terraces are computed from the outside face of exterior walls to the slab edges of the outside face of parapets. All illustrations reflect the artist's interpretation of the project and do not take into account the neighbourhood buildings, physical structures, streets and landscape. These materials will be governed entirely by the terms of the applicable disclosure statement and purchaser contract in each case. This is not an offering for sale. Any such offering can only be made with the applicable disclosure statement. Concord Park Avenue Limited Partnership. E&OE



8 & 15

PLAN C

1 BEDROOM

ENCLOSED AREA

515
SQ. FT.

BALCONY/TERRACE

55
SQ. FT.

TOTAL AREA

570
SQ. FT.

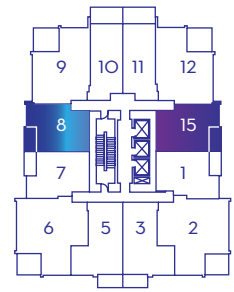

Actual suite plan may have minor variations from, or shown as mirror image of, the typical plan shown.

LOWER TYPICAL FLOORS **5-40**

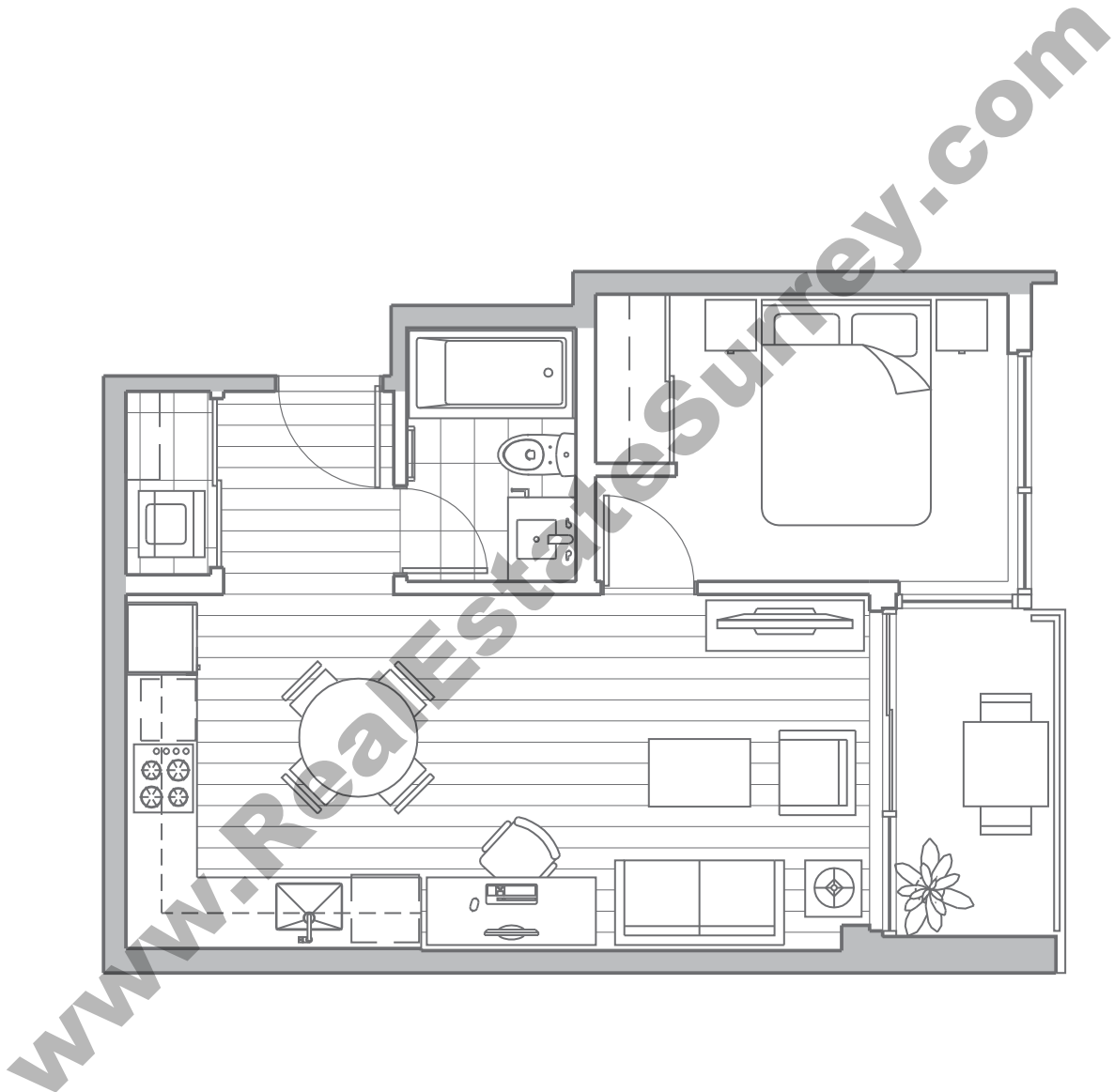

The developer reserves the right to make modifications and changes to features and finishes, brands, materials, building design, specifications, features, ceiling heights, flooring patterns and floor plans without notification. Suite sizes are computed 0.015m offset from the outside face of exterior walls, 0.015m offset from the outside face of walls adjacent to common areas and to the centreline of walls common to other suites. Measurements for exterior balconies and terraces are computed from the outside face of exterior walls to the slab edges of the outside face of parapets. All illustrations reflect the artist's interpretation of the project and do not take into account the neighbourhood buildings, physical structures, streets and landscape. These materials will be governed entirely by the terms of the applicable disclosure statement and purchaser contract in each case. This is not an offering for sale. Any such offering can only be made with the applicable disclosure statement. Concord Park Avenue Limited Partnership. E&OE



1&7

PLAN C1

1 BEDROOM

ENCLOSED AREA

512
SQ. FT.

BALCONY/TERRACE

55
SQ. FT.

TOTAL AREA

567
SQ. FT.

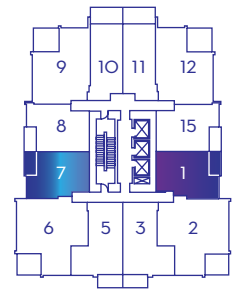

Actual suite plan may have minor variations from, or shown as mirror image of, the typical plan shown.

LOWER TYPICAL FLOORS 5-40

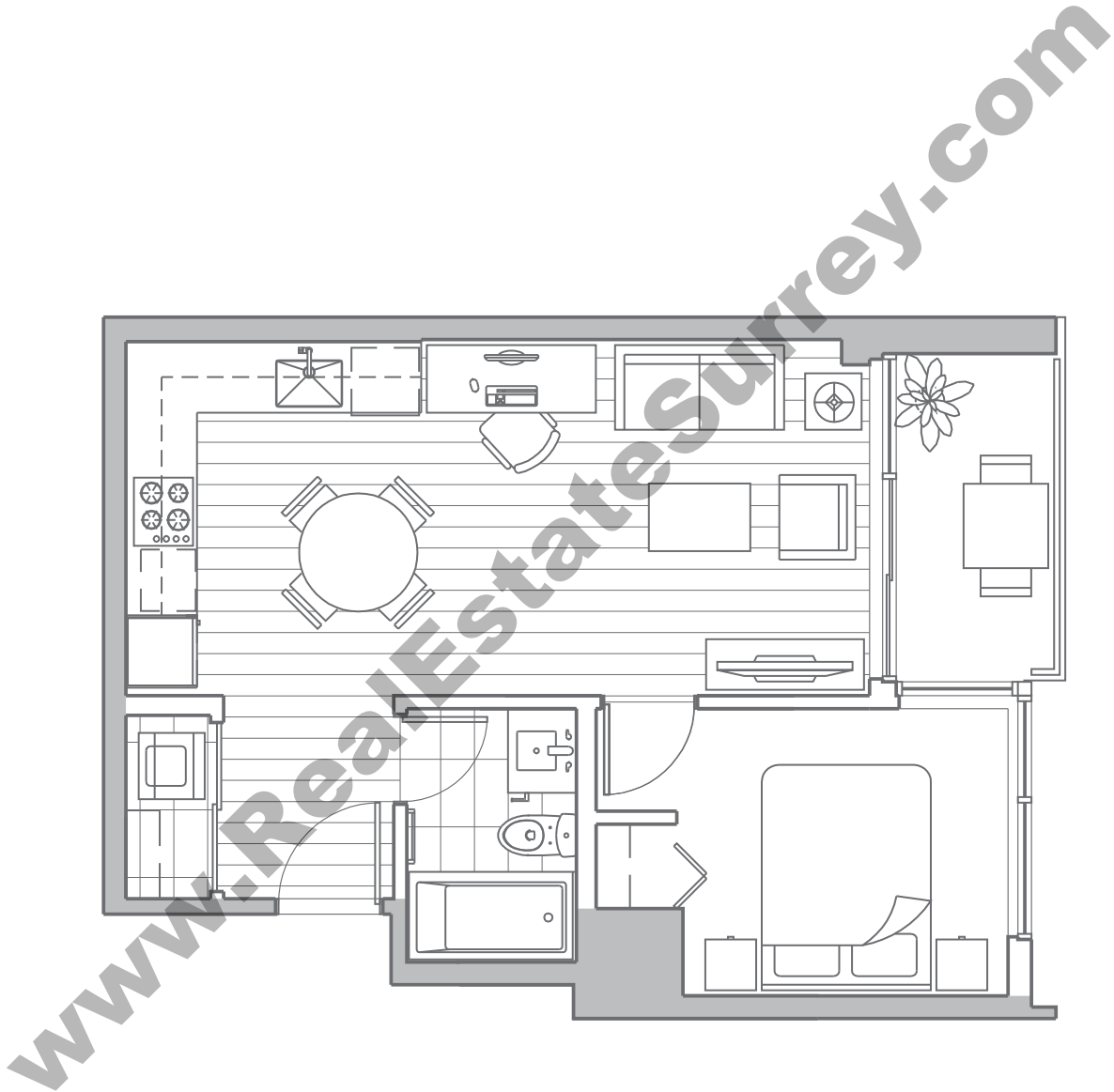

The developer reserves the right to make modifications and changes to features and finishes, brands, materials, building design, specifications, features, ceiling heights, flooring patterns and floor plans without notification. Suite sizes are computed 0.015m offset from the outside face of exterior walls, 0.015m offset from the outside face of walls adjacent to common areas and to the centreline of walls common to other suites. Measurements for exterior balconies and terraces are computed from the outside face of exterior walls to the slab edges of the outside face of parapets. All illustrations reflect the artist's interpretation of the project and do not take into account the neighbourhood buildings, physical structures, streets and landscape. These materials will be governed entirely by the terms of the applicable disclosure statement and purchaser contract in each case. This is not an offering for sale. Any such offering can only be made with the applicable disclosure statement. Concord Park Avenue Limited Partnership. E&OE



2 & 6

PLAN D

2 BEDROOM + STUDY

ENCLOSED AREA

785
SQ. FT.

BALCONY/TERRACE

102
SQ. FT.

TOTAL AREA

887
SQ. FT.

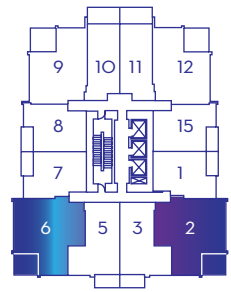

Actual suite plan may have minor variations from, or shown as mirror image of, the typical plan shown.

LOWER TYPICAL FLOORS 5-40

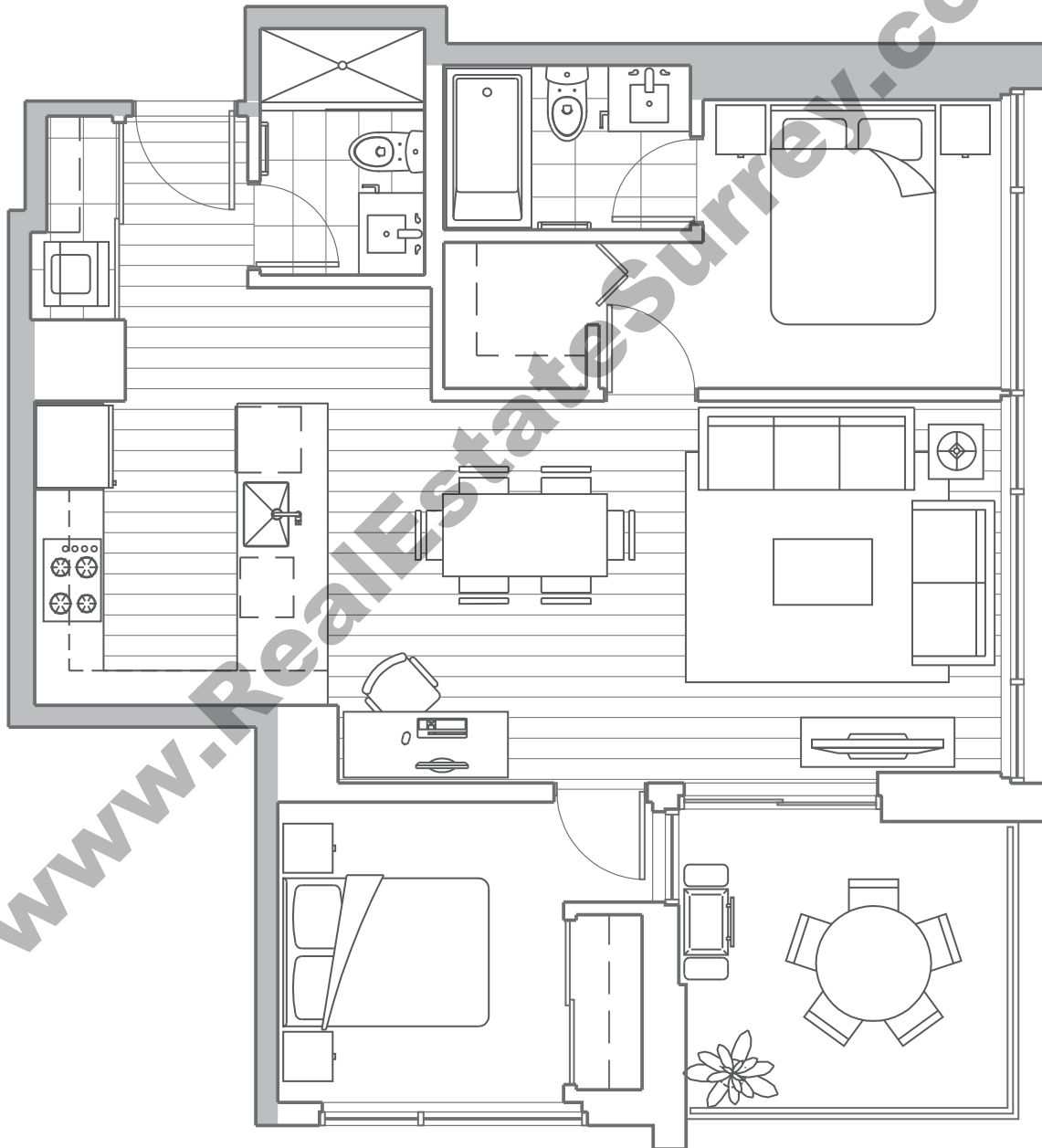

The developer reserves the right to make modifications and changes to features and finishes, brands, materials, building design, specifications, features, ceiling heights, flooring patterns and floor plans without notification. Suite sizes are computed 0.015m offset from the outside face of exterior walls, 0.015m offset from the outside face of walls adjacent to common areas and to the centreline of walls common to other suites. Measurements for exterior balconies and terraces are computed from the outside face of exterior walls to the slab edges of the outside face of parapets. All illustrations reflect the artist's interpretation of the project and do not take into account the neighbourhood buildings, physical structures, streets and landscape. These materials will be governed entirely by the terms of the applicable disclosure statement and purchaser contract in each case. This is not an offering for sale. Any such offering can only be made with the applicable disclosure statement. Concord Park Avenue Limited Partnership. E&OE



3 & 5

PLAN E

1 BEDROOM + DEN

ENCLOSED AREA

538
SQ. FT.

BALCONY/TERRACE

58
SQ. FT.

TOTAL AREA

596
SQ. FT.

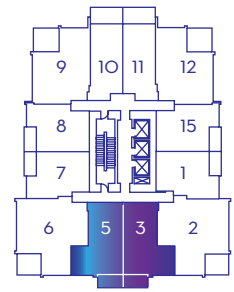

Actual suite plan may have minor variations from, or shown as mirror image of, the typical plan shown.

LOWER TYPICAL FLOORS 5-40

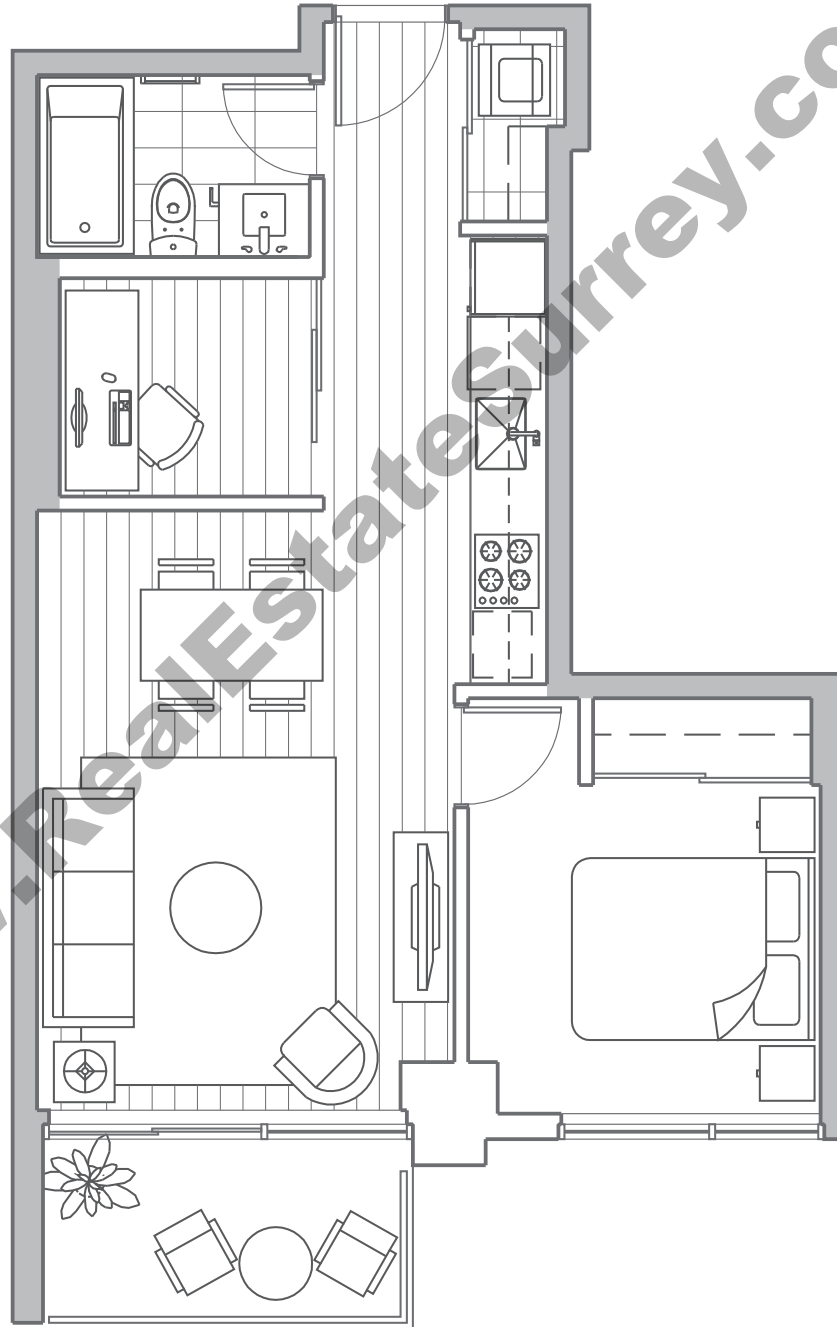

The developer reserves the right to make modifications and changes to features and finishes, brands, materials, building design, specifications, features, ceiling heights, flooring patterns and floor plans without notification. Suite sizes are computed 0.015m offset from the outside face of exterior walls, 0.015m offset from the outside face of walls adjacent to common areas and to the centreline of walls common to other suites. Measurements for exterior balconies and terraces are computed from the outside face of exterior walls to the slab edges of the outside face of parapets. All illustrations reflect the artist's interpretation of the project and do not take into account the neighbourhood buildings, physical structures, streets and landscape. These materials will be governed entirely by the terms of the applicable disclosure statement and purchaser contract in each case. This is not an offering for sale. Any such offering can only be made with the applicable disclosure statement. Concord Park Avenue Limited Partnership. E&OE